

- NEW CONSTRUCTION NOTES:**
1. REPAIR AND RESTORE ALL DISTURBED GRASSED AREAS W/ SOD- REFER TO MATERIAL QUANTITY NOTES BELOW OF TOPSOIL AND SOD REQUIRED
 2. PROVIDE COMPACTED GRAN. FILL AT DEMOLITION AREAS AS REQ'D. REFER TO MATERIAL QUANTITY NOTES BELOW TO SUIT ADJACENT SITE GRADING. REFER TO STRUCTURAL
 3. FINISH GRADES AT PERIMETER OF BUILDING TO SLOPE AWAY AT A MINIMUM OF 2% GRADE.
 4. CONFIRM LOCATION OF BUILDING ON SITE FOLLOWING POINT OF INSERTION SHOWN AT THIS DRAWING
 5. ACTUAL LOCATION OF ROADS, PROPANE GAS LINE, AND MANHOLE ARE FURTHER THAN APPEARS ON THIS DRAWING. LOCATIONS REVISED TO PROVIDE REFERENCES ON DRAWING
 6. NEW SLAB TO BE 100MM HIGHER THAN SLAB AT EXIST. BUILDING
- FIN. GRADE EL. 000.00 NEW GRADE ELEVATIONS
 FIN. GRADE EL. 000.00 EXISTING GRADE ELEVATIONS

- MATERIAL QUANTITIES TO BE INCLUDED IN SCOPE OF WORK UNDER CONTRACT:**
1. GRANULAR FILL (GRAVEL FOR PARKING AREA)- 5 CUBIC METERS
 2. COMPACTED GRANULAR FILL UNDER NEW BUILDING SLAB AND WALKS- 27 CUBIC METERS
 3. NEW TOP SOIL TO FILL GRASSED AREAS- 8 CUBIC METERS

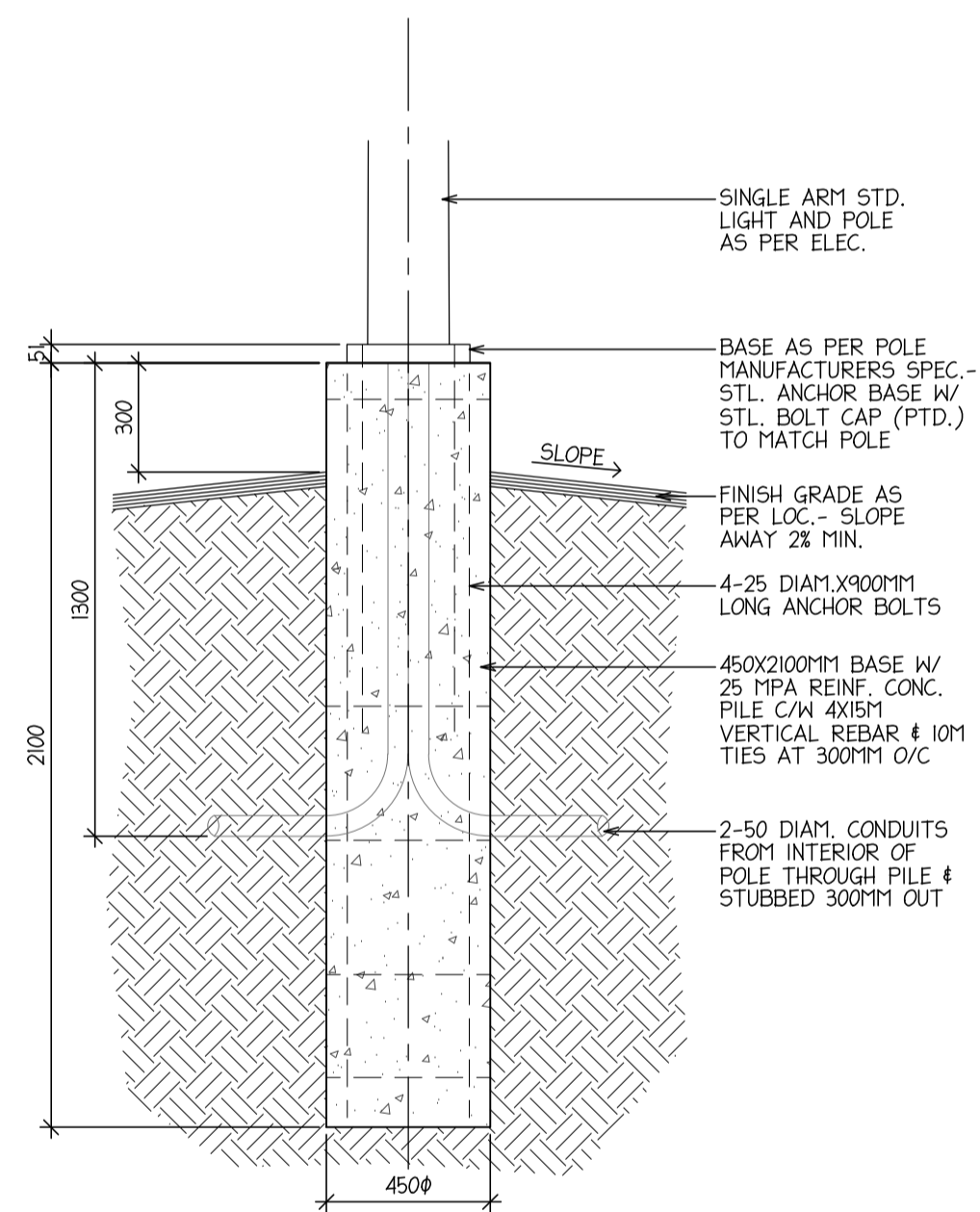

2 SECTION DETAIL- TYP. POLE LIGHT 1:20

1 SITE PLAN NEW CONSTRUCTION 1:100

ISSUED FOR TENDER/CONSTRUCTION 19-04-17
 ISSUED FOR FINAL REVIEW 29-04-16
 ISSUED FOR REVIEW 31-03-16
 ISSUED FOR REVIEW 75% 28-03-16
 ISSUED FOR REVIEW 50% 11-03-16
 ISSUED FOR OWNER REVIEW 12-02-16

- NOTES:**
1. THIS PLAN WAS PREPARED FOR THE GOVERNMENT'S INTERNAL PURPOSES ONLY. THE GOVERNMENT DOES NOT WARRANT THAT THIS PLAN IS APPROPRIATE FOR ANY OTHER PURPOSE OR LOCATION. NEITHER THE MINISTER NOR THE GOVERNMENT ACCEPTS ANY RESPONSIBILITY FOR ANY LOSSES OR DAMAGES ARISING FROM ANYONE USING THIS PLAN. THE USER MUST ENSURE THAT ANYTHING BUILT FROM THIS PLAN IS ADEQUATE AND SAFE FOR THE USER'S PARTICULAR SITE CONDITIONS. THIS SHALL INCLUDE, BUT SHALL NOT BE LIMITED TO, ALL FOUNDATION, STRUCTURAL, SAFETY, AND ANY OTHER APPLICABLE REQUIREMENTS.
 2. THE USER SHALL ALSO ENSURE THAT THIS PLAN WILL SUIT THE PARTICULAR SITE AND COMPLY WITH ANY OTHER RELEVANT FEDERAL, PROVINCIAL, OR MUNICIPAL REGULATIONS AND CODES WHICH MAY APPLY AT THE USER'S SITE.
 3. THE LOCATION OF THE UNDERGROUND SERVICES AS SHOWN IS APPROXIMATE ONLY. OTHER UNKNOWN SERVICES MAY EXIST IN THE VICINITY. PLEASE CHECK WITH THE APPROPRIATE UTILITY COMPANY AND THE PARK/SITE MAINTENANCE SUPERVISOR OR REPRESENTATIVE.
 4. IT IS THE RESPONSIBILITY OF ANYONE USING THIS PLAN FOR DESIGN PURPOSES TO VERIFY ALL INFORMATION SHOWN ON THIS PLAN. IT IS THE USER'S RESPONSIBILITY TO IDENTIFY ANY UTILITY INFRASTRUCTURE.

MAURICE SOULODRE ARCHITECT LTD
 1815C LORNE AVE
 SASKATOON, SK S7H 1Y5
 TEL (306) 955-0333
 FAX (306) 955-0549
 EMAIL soularch@sasktel.net

PROJECT
 SERVICE CENTRE REPLACEMENT
 MEADOW LAKE PROVINCIAL PARK

SANDY BEACH CAMPGROUND
 MINISTRY OF PARKS, CULTURE AND SPORT
 PARKS SERVICE BRANCH
 2nd FLOOR 3211 ALBERT STREET
 REGINA, SASKATCHEWAN
 S4S 5W6

DRAWING
 NEW SITE PLAN
 NEW AND EXISTING GRADING

SCALE:	1:200 (PLOT TITLE USE)
PLOTTED:	19-04-2017
FILE:	3556C
DATE:	APRIL 2017
DESIGN:	MS
DRAWN:	DU

	MEADOW LAKE PROVINCIAL PARK	LOCATION
	SANDY BEACH CAMPGROUND	
SERVICE CENTRE REPLACEMENT NEW SITE PLAN (NEW AND EXISTING GRADING)	PLAN NO. SHEET 3 OF 24 1008-30-F22-15C	

DRAWING NO. **A.101**